

X40 MINI-SPLIT CONDENSATE PUMP

Submittal Information

Part No.	18122
Document No.	SPEC18122
Date	2025-02-05
Revision	01

General Properties

- Power supply: 100-240V AC 50/60Hz <4W
- Max.flow: 40L(10.56 gal)/H @ 0 head
- Sound level: <19dB(A) @ 1m (3.28 ft)
- Max.recommended head: 20m (65.62 ft)
- Max.suction lift: 2m (6.56 ft)
- Max.unit output: 46KW / 157,000 Btu/h
- Safety switch: 3A Normally closed
- Max.water temperature: 70°C (158°F)
- Discharge tube: 6mm (1/4 in) ID
- Class: II appliance
- Rated: Continuous
- IP Protection: IPX5
- Fully potted: ✓

Specification

Item No.	Description	Std. Pkg	U/M
18122	X40 Mini-split Pump, Dual Vol, 10.6 GPH	1	EA

Features

- Its compact and slim design allows easy installation inside ducts.
- Operates with a float switch to detect water presence.
- Ensures silent operation for a peaceful environment.
- Provides powerful and efficient drainage of condensate water.
- Designed for mini split systems.

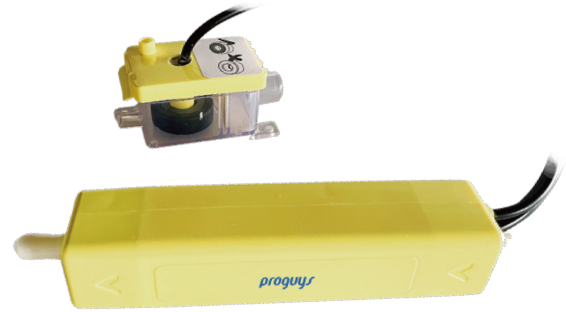

Accessories List

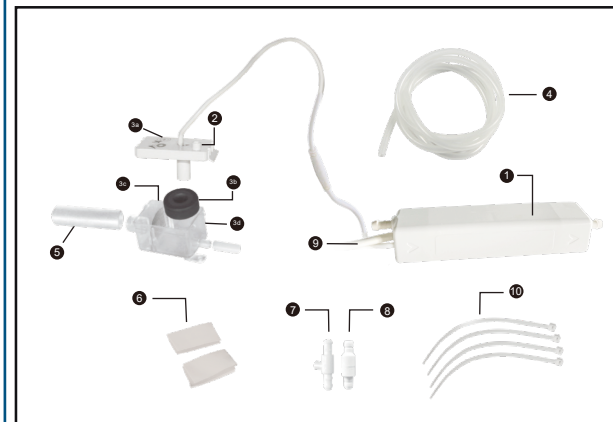

- | | |
|--|---------------------------------------|
| 1 Assembled | 4 5 ft length of 1/4 in ID vinyl tube |
| 2 1/4 in ID vinyl tube | 5 Inlet tube |
| 3 Assembled Inline reservoir, including: | 6 2 x self adhesive velcro strips |
| • lid & sensor cable | 7 Anti-siphon valve |
| • float | 8 Check valve |
| • filter | 9 Power cable |
| • reservoir | 10 4 x 8 in x 3/16 in cable ties |

***NOTE:** You will need several metres of 3/8 in OD x 1/4 in ID vinyl tube.

Performance Data

